

Vacant land

52	59.5	59.5	138	13.75
27.5	29.75	4	13.75	138
24.5	1.5	238.01	6.90	11000
7.85	96.5	7	966	4125
80	127.94		138	1375
112.35			241.51	1897.50
138		29.120	81	23
896		1.80		1
0456		96.96		
1545	6	11.138		
109	96	139.434		

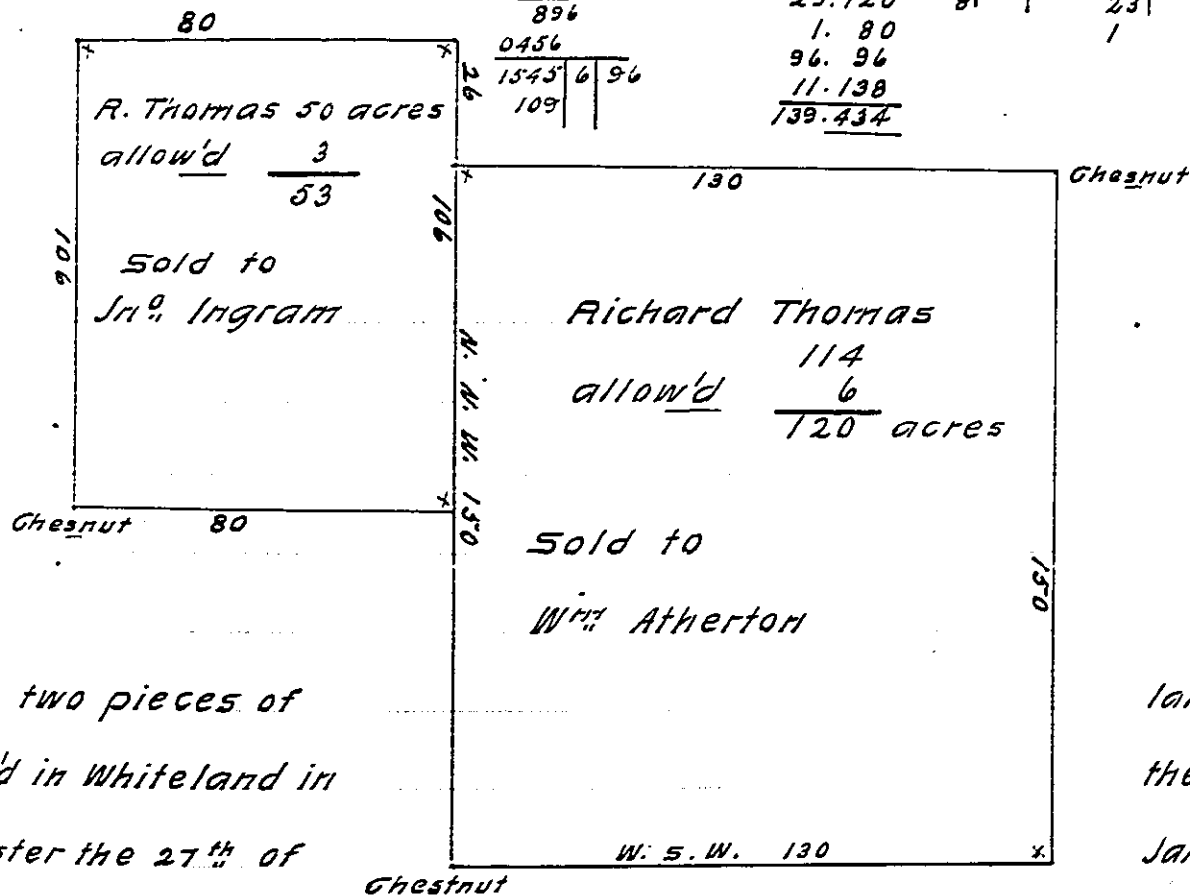

These two pieces of land were surveyed in Whiteland in the County of Chester the 27th of January 1729-30. At the request of Richard Thomas but he having before taken up and sold all the land due to him by his fathers purchase of 5000^a at his request ye 133-above was granted to Thomas Atherton by warrant from the Propriet^{rs} dated ye 31st of Janu^{ry} 1734 and returned into the Secretarys office the 29th of March 1735. See the survey & record of the return.

IN TESTIMONY that the above is a copy of the original remaining on file in the Department of Internal Affairs of Pennsylvania, made conformably to an Act of Assembly approved the 16th day of February, 1833, I have hereunto set my Hand and caused the Seal of said Department to be affixed at Harrisburg, this sixth day of April 1909

Henry Howard
Secretary of Internal Affairs.